

RELAUNCH

A 4-WEEK ONLINE COACHING EXPERIENCE

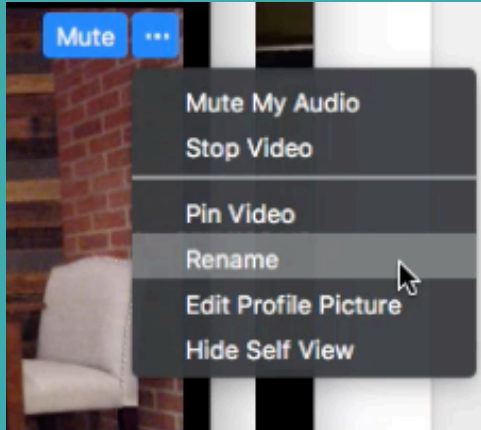



-Your Full

2 – Danny Parmelee

Rename Yourself

1. St. Louis
2. Southern Region (IN,TN, KY AR)
3. Central Illinois
4. Chicago City
5. Northern Michigan
6. Detroit
7. Grand Rapids
8. Kalamazoo
9. North Chicago Suburbs
10. Mid Chicago Suburbs
11. South Chicago Suburbs
12. Other

Download & Print Worksheets

RELAUNCH

Week 4 - Weekly Leader Reflection Worksheet

Take ten minutes to describe and discuss your discipleship path way.

WHAT IS WORKING?

WHAT IS NOT WORKING?

WHAT IS MISSING?

*"What after all, is Apollos? And what is Paul?
Only servants, through whom you came to believe -
as the Lord has assigned to each his task.
I planted the seed, Apollos watered it, but God made it grow."
1 Corinthians 3:5-6*

CONVERGE
MIDAMERICA

convergemidamerica.org

What is the Missing Ingredient to Leadership Development?



Discipleship is
the missing
ingredient!

Jesus did not tell us to “go make leaders” but he did tell us to “go make disciples” (Matthew 28:19-20).

If your church does not have a strong spiritual formation plan it will have a weak leadership development plan.

Not every disciple will be a leader but every leader must be a growing disciple reproducing the life of Christ in others

1) Have a reproducible discipleship process that helps you identify leaders out of the harvest.

In your current pathway where are potential leaders identified?

GraceRiver Church

NEXT STEPS

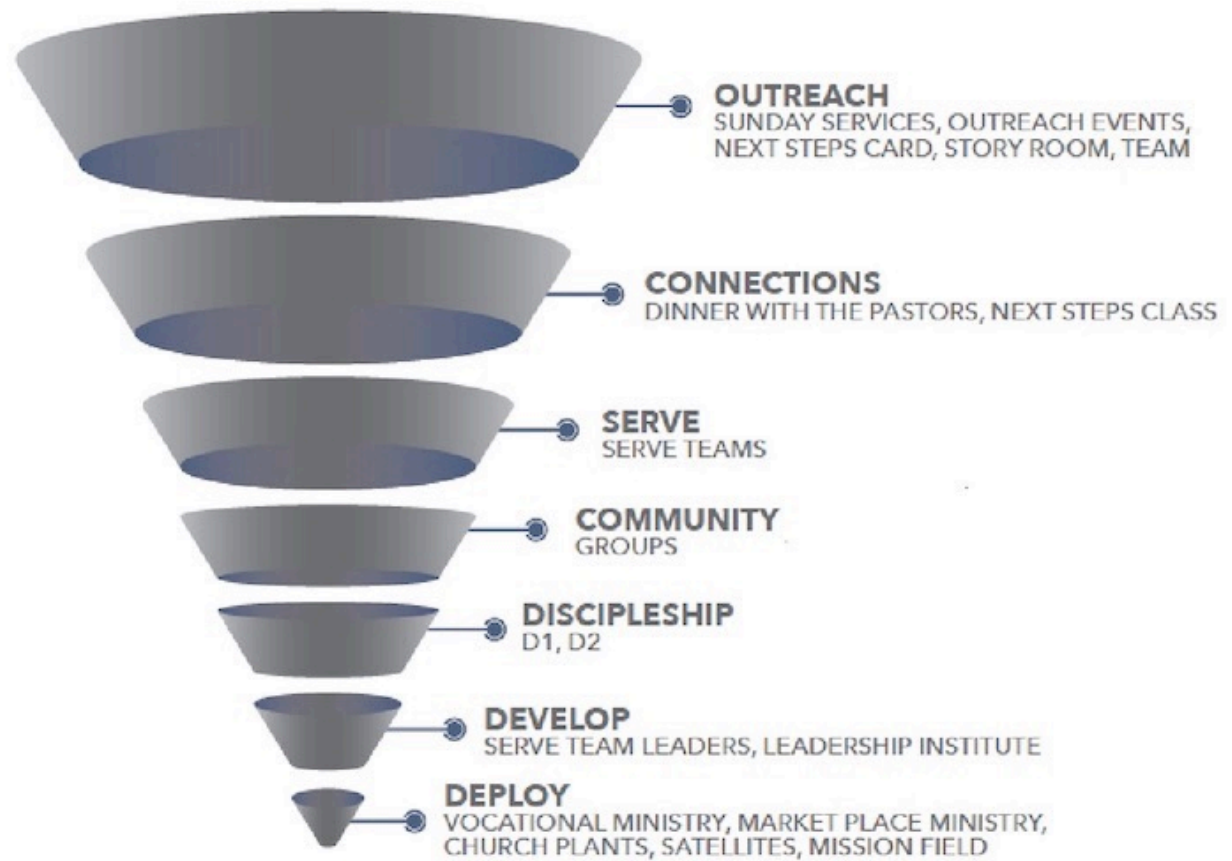

Rick Warren's Purpose Driven Approach

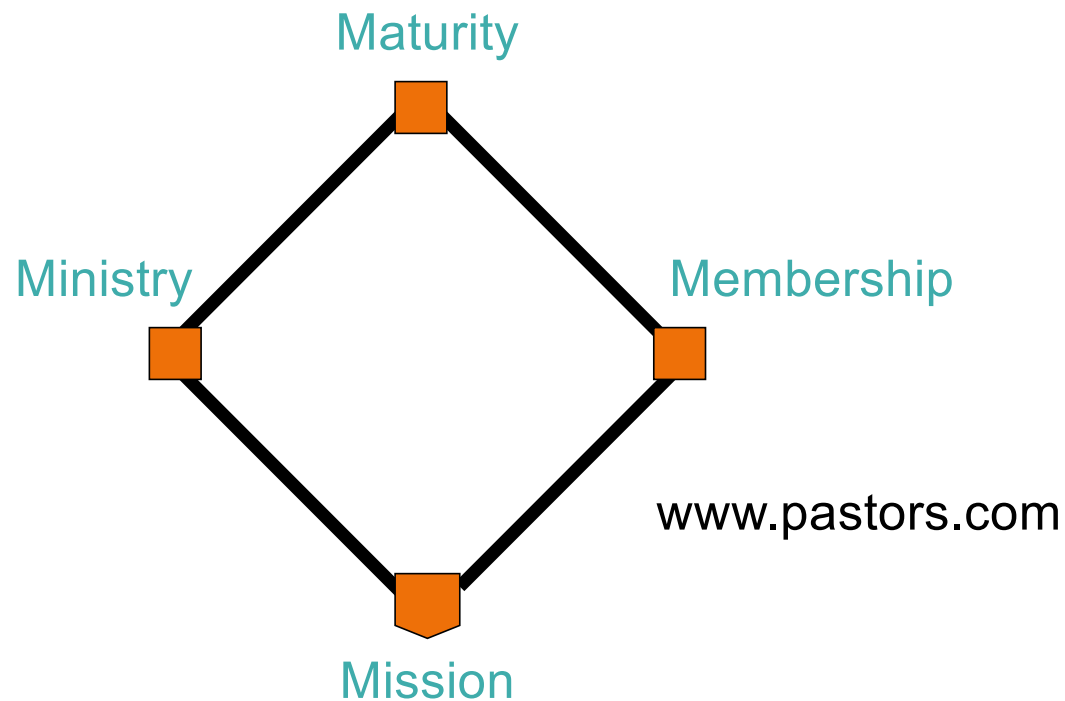

Growth Track

- 1) Family
- 2) Essentials
- 3) Purpose
- 4) Dream Team

growth track



<http://www.onechurchresource.com/growth-track>

<https://www.one.church/growthtrack>

SEARCHERS



FOLLOWERS



Not Interested

- Aware but not interested.
- OK for you, but it's not for me.
- Many misconceptions of Christianity.
- Negative view of Christianity and religion.
- Believe all religions are the same.
- Have an indifferent attitude toward spiritual issues.

Resisting



Questioning Regularly

- Realize there is more to life than what they see.
- Attend church events out of curiosity, not because of need.
- Still struggle with negative image of Christianity.
- Questioning the belief that all religions lead to the same God.

Questioning



Searching Assertively

- Understand the implications of Christ's claims.
- Understand the difference between Christianity and religion.
- Struggle with intellectualizing Christianity.

Responding



Faith Commitment

- Realized that they are powerless to achieve God's promises.
- Made a decision to turn their lives and wills over to the care and control of Jesus.

Embracing



Experiencing New Life

- Has entered into a mentoring relationship with another follower.
- Grasping the assurance of salvation.

Adjusting



Growing in Community

- A growing intimacy with God through prayer and Bible study.
- A deepening relationship with other followers of Christ.

Stabilizing



Living Missionally

- Deeply intimate with God through the practicing of spiritual disciplines.
- Sharing their faith effectively.
- Mentoring others spiritually.
- Living generously.

Reproducing

Bible 101

Christianity 101

Spiritual Foundation

Biblical Values

Life/Ministry Skills

Character Issues

<https://www.yourjourneyresources.com/Discipleship-s/25.htm>

**2) Be a
“disciple” first
and a pastor
second.**

**The more successful you are at developing
disciples the more successful you will be at
developing leaders.**

**Who are you investing in spiritually on a
weekly basis?**

Dual Level Process

Seminar Approach



One-on-One Approach



3) Get your best people investing their lives in others through discipleship.

One of the covenant statements we had with our staff and our elders is that they would invest in at least one person every year by taking them through our discipleship material with the goal of seeing those they invested in repeating the process with someone else.

Discipleship
Engine =
Leadership
Engine

Every church needs a leadership engine. Your discipleship process is the fuel to make the engine hum.

Solving the discipleship issues in your church will be the key to solving your leadership issues.

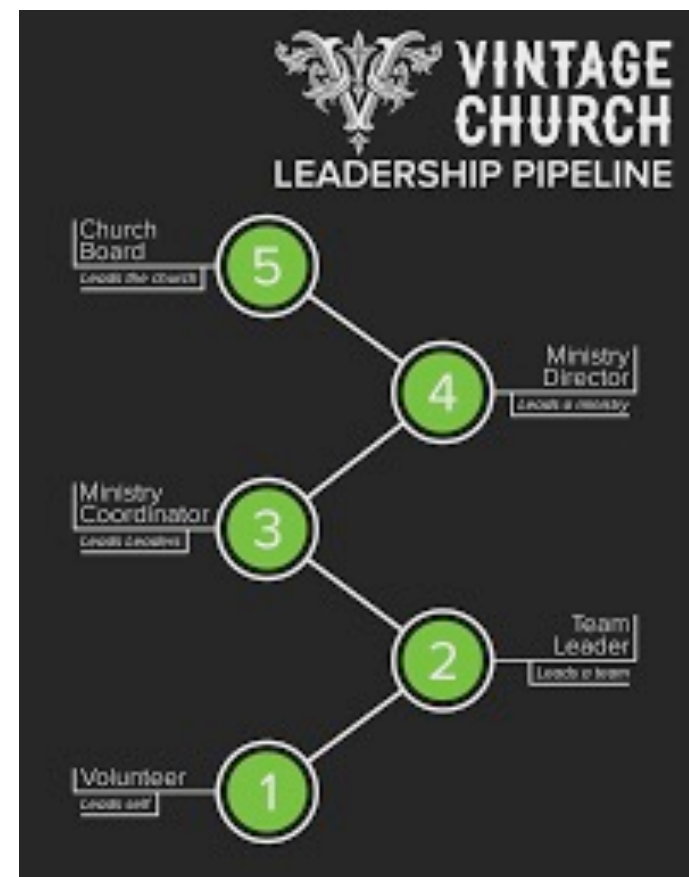

Breakout Time



Take 10
minutes at the
beginning of
the breakout
time to fill out
the worksheet.

RELAUNCH

Week 4 - Weekly Leader Reflection Worksheet

Take ten minutes to describe and discuss your discipleship path way.

WHAT IS WORKING?

WHAT IS NOT WORKING?

WHAT IS MISSING?

Breakout Time



Leadership Reflection

**What are the three “must wins”
you need to have this week to see
your relaunch become a reality?**

Wellness Check

We recognize that life and ministry are stressful and being compounded with the COVID-19 pandemic.

To help with this reality, we compiled a listing of MAP Counselors throughout our region who are currently offering telehealth counseling.

Just click “Telehealth Counseling” below to see counselors in your state offering telehealth counseling. You can contact a counselor directly to make an appointment.

<https://convergemidamerica.org/counselors/>

Some Closing Thoughts

- Day of prayer and fasting June 9. Zoom call prayer meeting at 2pm CST.
- Two new podcasts:

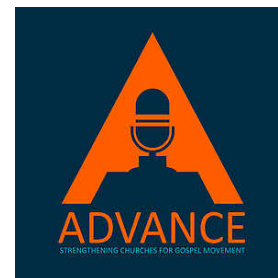

See You On June 9th For Prayer and Fasting

Feel free to invite another Pastor to join us

